

Wade Williams  
Mark W. Hoffman  
Frank Zulski, Jr.  
Brent Shank, PE  
Engineer-Manager  
Lisa Kleeman  
Finance Director

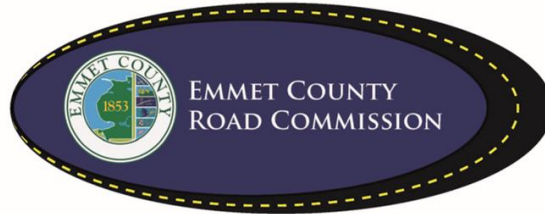

2265 E. Hathaway Road  
Harbor Springs, MI 49740  
Office: (231) 347-8142  
Fax: (231) 347-5787  
[www.emmetcrc.org](http://www.emmetcrc.org)

## PROPOSAL

Project: **2023 McKinley Twp Gravel Supply Project**

The Emmet County Road Commission will accept Bids until **9:00 a.m.** local time on **August 1, 2023** at: 2265 E. Hathaway Road, Harbor Springs, MI 49740. Bid packages are available at the Emmet County Road Commission Office or on Emmet County Road Commission website at [www.emmetcrc.org](http://www.emmetcrc.org).

**ALL BIDS WILL BE SEALED AND PLAINLY MARKED AS TO THE PROJECT AND PROJECT NUMBER.**

The bidder has examined the plans, specification, special provisions and related materials in the proposal, as well as the location of the work described in the proposal for this project and is fully informed as to the nature of the work and conditions relating to its performance and understands that the quantities shown are approximate only and are subject to either increase or decrease.

The bidder hereby proposes to furnish all necessary machinery, tools, apparatus and other means of construction, do all the work, furnish all the materials except as otherwise specified and, or each unit price, lump sum, or one each named in the itemized bid, to complete the work in strict conformity with the plans therefore and the entire proposal which is incorporated by reference in these pages, and in strict conformity with the requirements of the 2020 Standard Specifications for Construction, Michigan Department of Transportation and such other special provisions and supplemental specifications as may be part of the proposal for this project.

The bidder further proposes to do such extra work as may be authorized by the Emmet County Road Commission, prices for which are not included in the itemized bid. Compensation shall be made on the basis agreed upon before such extra work is begun.

THE BIDDER UNDERSTANDS AND AGREES THAT THE EMMET COUNTY ROAD COMMISSION RESERVES THE RIGHT TO REJECT ANY AND ALL BIDS; TO WAIVE IRREGULARITIES OR INFORMALITIES; AND NO CONTRACTUAL RELATIONSHIP SHALL EXIST BETWEEN THE BIDDER AND THE EMMET COUNTY ROAD COMMISSION FOR THE WORK DESCRIBED HEREIN UNTIL SUCH TIME AS THE CONTRACT HAS BEEN FORMALLY EXECUTED BY BOTH THE BIDDER AND THE EMMET COUNTY ROAD COMMISSION.

## **2023 McKinley Twp Gravel Supply Project**

### **Project Information:**

Job Location: **Ball Road** – US-31 to Reed Road  
**Gravel Supply** to Morrow Pit on Reed Road (1.2 mile north of Levering Road)

Type of Work: Aggregate Surface Course supply and delivery to job locations

Owner: Emmet County Road Commission

Completion Date: September 15, 2023

### **Aggregate Surface Course:**

Aggregate Surface, Cse shall meet MDOT specifications. The Contractor shall provide a scale ticket for each load delivered to the job. All scale tickets shall meet MDOT requirements. The Contractor shall provide current scale certification to the Road Commission prior to hauling material. Loader scales will not be accepted.

Aggregate Surface, Cse material shall be a 100% crushed limestone Dense-Graded Aggregate 23A or 23AA.

### **Ball Road Location**

- The Contractor shall ensure that an adequate number of trucks are available to provide a minimum delivery rate of 250 tons per hour.
- The last load must be on delivered to Ball Road location by 4:00 pm each day (Monday thru Thursday).
- The Emmet County Road Commission will provide traffic control, grading and compaction.

### **Morrow Pit Location**

- Contractor shall deliver material within 2 calendar days from starting haul.
- The last load to Morrow Pit location by 5:30 p.m. each day (Monday thru Friday).
- Emmet County Road Commission staff will push up stockpiled material at the Morrow Pit location periodically.

Project Location Map:

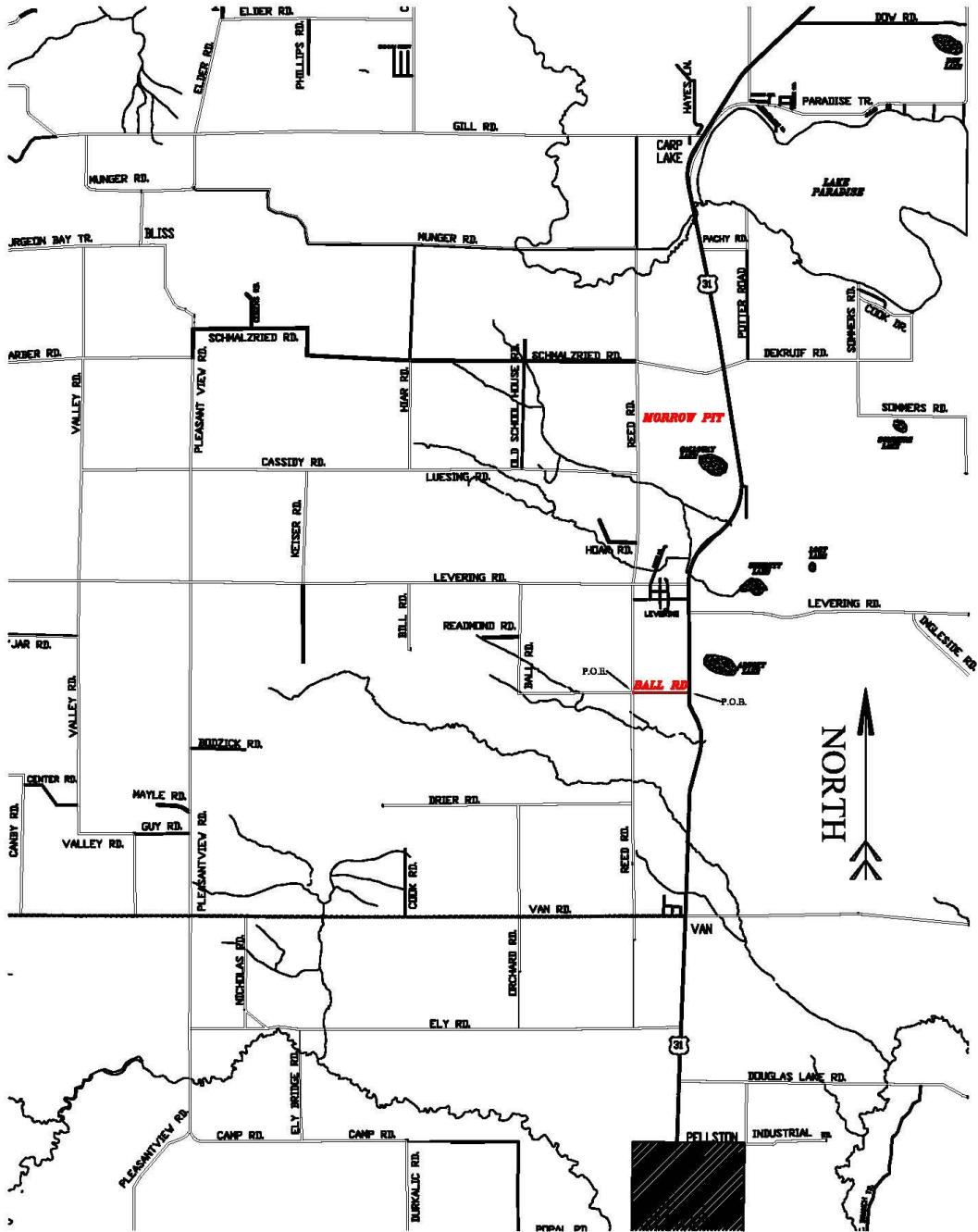

**Project Coordination:**

Contractor shall coordinate all work with Emmet County Road Commission Project Manager, Travis L. Horrocks. Contractor shall notify the Project Manager a minimum of 7 calendar days prior to work starting.

**Insurance Requirements:**

The Contractor shall furnish proof of general liability insurance in amounts not less than \$2,000,000 each occurrence and general aggregate, proof of automobile liability in amounts not less than \$2,000,000 combined single limit for each accident, bodily injury per accident, and property damage per accident, and in amount not less than \$1,000,000 for bodily injury per person. Such proof of insurance shall include a valid certificate of insurance demonstrating that the Emmet County Road Commission is additional insured party on the policy. Such insurance shall cover a period not less than the term of the project and shall provide that it cannot be cancelled without 30 days advanced written notice to the Emmet County Road Commission, by certified mail, first class, return receipt requested. The Contract/Project Agreement will be invalid if insurance expires during the authorized period of work described.

In addition to any liability or obligation by the Contractor that may otherwise exist, Contractor shall, to the fullest extent permitted by law, indemnify and hold harmless the Emmet County Road Commission and its commissioners, officers, agents and employees from and against any and all claims, actions, proceedings, liabilities, losses, and damages thereof, and any and all costs and expenses, including legal fees, associated therewith which the Emmet County Road Commission may sustain by reason of claims for or allegations of negligence or violation of the terms and conditions of the Contract/Project Agreement, arising out of the work which is subject of the Contract.

**Project Quantities:**

**Ball Road Location**

Aggregate Surface, Cse                    1730    Ton

**Morrow Pit Location**

Aggregate Surface, Cse                    1300    Ton

**Bid Sheet**

Board of Emmet County Road Commissioners  
2265 East Hathaway Road  
Harbor Springs, MI 49740

Gentlemen:

The undersigned proposes to furnish any and all materials, labor, and equipment necessary for the for the gravel supply for the 2023 McKinley Twp Gravel Supply Project as spelled out in the "Invitation to Bid" for the prices below.

The Emmet County Road Commission reserves the right to reject any and/or all bids based on what is in the best interest of Emmet County.

Contractor Name: \_\_\_\_\_

Project:  
2023 McKinley Twp Gravel Supply Project

Item	Quantity	Unit	Unit Price	Total
Aggregate Surface Cse	3030	Ton		
TOTAL PROJECT COST ESTIMATE =				

Bidder: \_\_\_\_\_  
\_\_\_\_\_

Address: \_\_\_\_\_  
\_\_\_\_\_

Signature: \_\_\_\_\_

Phone No.: \_\_\_\_\_

Printed Name: \_\_\_\_\_

Date: \_\_\_\_\_

Title: \_\_\_\_\_

Email: \_\_\_\_\_