

Wade Williams
Mark W. Hoffman
Frank Zulski, Jr.
Brent Shank, PE
Engineer-Manager
Lisa Kleeman
Finance Director

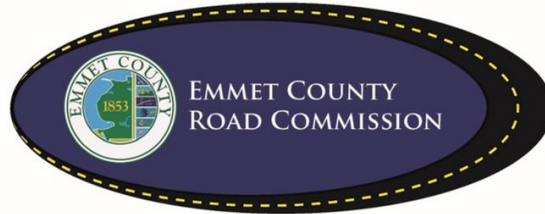

2265 E. Hathaway Road
Harbor Springs, MI 49740
Office: (231) 347-8142
Fax: (231) 347-5787
www.emmetcrc.org

PROPOSAL

Project: **Old US 31**

HMA Base Crushing

The Emmet County Road Commission will accept Bids until **9:00 a.m.** local time on **September 14, 2023** at: 2265 E. Hathaway Road, Harbor Springs, MI 49740. Bid packages are available at the Emmet County Road Commission Office or on Emmet County Road Commission website at www.emmetcrc.org.

ALL BIDS WILL BE SEALED AND PLAINLY MARKED AS TO THE PROJECT AND PROJECT NUMBER.

The bidder has examined the plans, specification, special provisions and related materials in the proposal, as well as the location of the work described in the proposal for this project, and is fully informed as to the nature of the work and conditions relating to its performance and understands that the quantities shown are approximate only and are subject to either increase or decrease.

The bidder hereby proposes to furnish all necessary machinery, tools, apparatus and other means of construction, do all the work, furnish all the materials except as otherwise specified and, or each unit price, lump sum, or one each named in the itemized bid, to complete the work in strict conformity with the plans therefore and the entire proposal which is incorporated by reference in these pages, and in strict conformity with the requirements of the 2020 Standard Specifications for Construction, Michigan Department of Transportation and such other special provisions and supplemental specifications as may be part of the proposal for this project.

The bidder further proposes to do such extra work as may be authorized by the Emmet County Road Commission, prices for which are not included in the itemized bid. Compensation shall be made on the basis agreed upon before such extra work is begun.

THE BIDDER UNDERSTANDS AND AGREES THAT THE EMMET COUNTY ROAD COMMISSION RESERVES THE RIGHT TO REJECT ANY AND ALL BIDS; TO WAIVE IRREGULARITIES OR INFORMALITIES; AND NO CONTRACTUAL RELATIONSHIP SHALL EXIST BETWEEN THE BIDDER AND THE EMMET COUNTY ROAD COMMISSION FOR THE WORK DESCRIBED HEREIN UNTIL SUCH TIME AS THE CONTRACT HAS BEEN FORMALLY EXECUTED BY BOTH THE BIDDER AND THE EMMET COUNTY ROAD COMMISSION.

Old US 31

Project Information:

Job Location: Camp Daggett Road to Horton Bay Road and Horton Bay Road to US-31

Type of Work: HMA Base Crushing

Owner: Emmet County Road Commission

Project Dates:

Project Start Date: 10 Days after all Contracts are executed.

Project Completion Date: October 15, 2023

The project shall be completed within 5 (five) days of starting date.

Project Location Map:

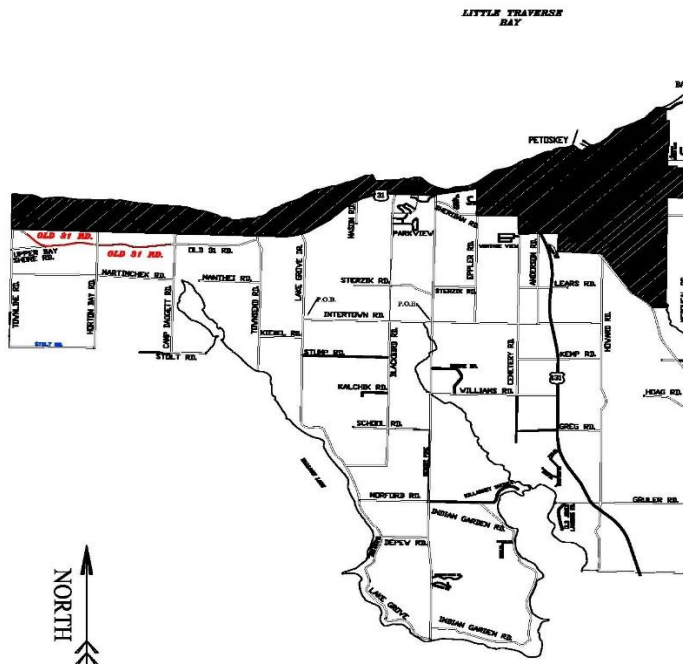

Soil Boring information:

US-31 to Horton Bay Road (Area 1):

0" to 2"	HMA Surface
2" to 5"	Aggregate Base Material (thickness varies from 0" to 5", most commonly 2" to 3")
5" to 13"	Concrete Slab (non-reinforcement)
13" to 20"	Native Ground (Sandy Organic Material)
16" to 24"	Sandy Organic Material

Horton Bay Camp Daggett Road (Area 2):

0" to 2"	HMA Surface
2" to 10"	Rubblized Concrete (2" to 4" minus)
10" to 16"	Aggregate Base material
16" to 24"	Native Ground: Sandy Organic Material

HMA Base Crushing and Shaping:

Contractor to provide material, equipment, and labor for base crushing. Base Crushing width is 20.0' feet.

We will be asking for 2 separate prices for base crushing, one for US-31 to Horton Bay Road & Horton Bay Road to Camp Daggett Road.

Area 1: Base Crushing shall be 1" above concrete slab below HMA surface.

Area 2: Base Crushing shall be 4" below existing HMA surface.

Emmet County Road Commission will provide traffic control, grading and compaction. Project will have to be coordinated with ECRC to start during normal working hours.

Normal working hours for ECRC:

Until 9/21/23 will be 6 a.m. to 4:30 p.m. Monday thru Thursday.

Starting 9/25/23 and after will be 7 a.m. to 3:30 p.m. Monday thru Friday.

General Note:

All work being performed will be conducted in the safest manner possible and appropriate PPE shall be used at all times. All work shall be done in accordance with the Michigan Department of Transportation 2020 Standard Specification for Construction. Contractor assumes all responsibilities for Quality Control (QC) to assure the plans and specifications are met per the contract and to provide professional craftsmanship in each task being performed. Any errors in plans or discrepancies found in the field shall be brought to the engineer's attention immediately. All materials shall meet the requirements of the Michigan Department of Transportation Materials Source Guide.

Insurance Requirements:

The Contractor shall furnish proof of general liability insurance in amounts not less than \$2,000,000 each occurrence and general aggregate, proof of automobile liability in amounts not less than \$2,000,000 combined

single limit for each accident, bodily injury per accident, and property damage per accident, and in amount not less than \$1,000,000 for bodily injury per person. Such proof of insurance shall include a valid certificate of insurance demonstrating that the Emmet County Road Commission is additional insured party on the policy. Such insurance shall cover a period not less than the term of the project and shall provide that it cannot be cancelled without 30 days advanced written notice to the Emmet County Road Commission, by certified mail, first class, return receipt requested. The Contract/Project Agreement will be invalid if insurance expires during the authorized period of work described.

In addition to any liability or obligation by the Contractor that may otherwise exist, Contractor shall, to the fullest extent permitted by law, indemnify and hold harmless the Emmet County Road Commission and its commissioners, officers, agents and employees from and against any and all claims, actions, proceedings, liabilities, losses, and damages thereof, and any and all costs and expenses, including legal fees, associated therewith which the Emmet County Road Commission may sustain by reason of claims for or allegations of negligence or violation of the terms and conditions of the Contract/Project Agreement, arising out of the work which is subject of the Contract.

Bonding Requirements:

Bonding is not required for projects under \$50,000.00

The successful Contractor shall furnish a performance bond equal to the contract price as assurance for faithful contract performance.

The Contractor shall also furnish a separate **surety bond** equal to the contract price as security for payment to all persons performing labor and furnishing materials in connection with this contract. The Contractor shall pay the premium for all bonds.

The bonds must meet requirements of Michigan Law.

Bonds shall be submitted and approved before contract execution.

Liquidated Damages:

Liquidated damages will be assessed for failure to complete this project by the specified date, or by the allowed number of days specified once work begins, due to lack of effort, poor organization or ability to perform on the Contractor’s part. Liquidated Damages may be waived by the Project Engineer. Liquidated damages will be assessed according to the table below:

Project Award Amount	Liquidated Damages
\$0 - \$150,000	\$500 per Calendar Day
\$150,001 - \$500,000	\$750 per Calendar Day
Over \$500,000	\$1,000 per Calendar Day

Stations:

Old US-31

0+00	Centerline US-31
12+50	P.O.B. <u>Area 1</u>
21+50	Centerline Upper Bay Shore Road
50+65	P.O.E. <u>Area 1</u>
52+25	Centerline Horton Bay Road
53+25	P.O.B. <u>Area 2</u>
98+92	P.O.E. <u>Area 2</u>
99+77	Centerline Camp Daggett Road

Project Quantities:

Area 1

HMA Base Crushing and Shaping 8478 Syd

Area 2

HMA Base Crushing and Shaping 10149 Syd

Bid Sheet

Board of Emmet County Road Commissioners
2265 East Hathaway Road
Harbor Springs, MI 49740

Gentlemen:

The undersigned proposes to furnish any and all materials, labor, and equipment necessary for the reconstruction of Old US-31 as spelled out in the "Invitation to Bid" for the prices below.

The Emmet County Road Commission reserves the right to reject any and/or all bids based on what is in the best interest of Emmet County.

Contractor Name: _____

Project:
Old US-31

Item	Quantity	Unit	Unit Price	Total
Area 1, HMA Base Crushing	8478	Syd		
Area 2, HMA Base Crushing	10149	Syd		

Emmet County Road Commission may choose to award: Area 1, Area 2, or Both Area 1 and Area 2.

Bidder: _____

Address: _____

Signature: _____

Phone No.: _____

Printed Name: _____

Date: _____

Title: _____

Email: _____

